

## Rubberised magnet systems

### NdFeB magnetic system, white rubber sheath, with cylinder bore

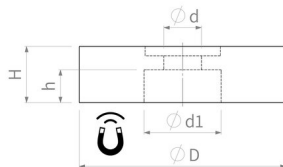

Article number	D mm	d mm	d1 mm	H mm	h mm	Adhesive force* N	Shear force* N	Weight g	Temperature °C	Surface
A18C-KwB3.0H6	18	3	8.2	6	3,5	25	7	5.5	60	white
A22C-KwB4.0H6	22	4	8.2	6	3,5	38	12	8	60	white
A31C-KwB6.0H6	31	6	9	6	3,5	89	15	20	60	white
A31C-KwB6.0H8	31	6	9	8,5	3,5	89	15	20	60	white
A57C-KwB8.0H7.6	57	8	25	7,6	3,3	200	68	77	60	white
A66C-KwB5.5H8.5	66	5.5	22	8,5	3,2	250	75	100	80	white

#### PRODUCT NOTE:

Thanks to their **rubber coating**, these magnetic systems are perfect for use on sensitive surfaces. They protect the surface from scratches and, thanks to the light-coloured coating, from colour transfer and at the same time increase the frictional force in the event of displacement. This magnetic system with a **cylinder bore** is mounted by screwing it on with a screw without countersinking.

As an alternative to the standard version, we also offer customised solutions:

- " Other colours for the rubber coating
- " Harder or softer rubber coating