

## Flat pot magnets of hard ferrite

### Pot magnets made of hard ferrite, stainless steel housing, with cylinder bore

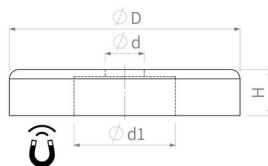

Article number	D mm	d mm	d1 mm	H mm	Adhesive force* N	Weight g	Temperature °C
F50C-4016	50 <sup>+0.2</sup> / <sub>-0.1</sub>	8,5 <sup>+0.2</sup> / <sub>-0.2</sub>	22	10 <sup>+0.5</sup> / <sub>-0.2</sub>	145	85	220
F63C-4016	63 <sup>+0.3</sup> / <sub>-0.1</sub>	6,5 <sup>+0.2</sup> / <sub>-0.2</sub>	24	14 <sup>+0.5</sup> / <sub>-0.2</sub>	230	195	220

#### PRODUCT INFORMATION:

Do you need a reliable pot magnet that can also be used outdoors? Our models with **stainless steel housing** offer you an excellent alternative to conventional pot magnets made of galvanised steel. They are more robust, more durable and more resistant to chemicals and high temperatures. Although the adhesive force of ferrite magnets is slightly lower than that of neodymium magnets, they impress with their attractive price and versatility.

Thanks to the **cylindrical bore** of this magnet system, you can easily attach it to a counterpart of your choice using a screw without countersinking.

\* The forces have been determined at room temperature on a polished plate made of steel (S235JR according to DIN 10 025) with a thickness of 10 mm (1kg~10N). A deviation of up to -10% from the specified value is possible in exceptional cases. In general, the value is exceeded. The type of application (installation situation, temperatures, counter anchors, etc.) sometimes influence the forces enormously. The values given are for orientation purposes. Let our experts advise you.